

INSTALLATION AND OPERATION MANUAL

DESCRIPTION

FLOJET Water Boost Systems are designed to provide optimum pressure to beverage dispense systems to ensure maximum drink quality and longevity of equipment. The large capacity tank can support multiple systems through peak demand and system pressure fluctuations. An ideal solution to compensate for pressure drops due to plumbing filtration and long runs. The pump is fully automatic with an integral rapid react switch for immediate response.

TYPICAL APPLICATIONS

- Beverage dispense systems
- Carbonators, ice machines, water dispensers
- Water filtration systems
- Non-carbonated drink dispensing valves
- Coffee and tea brewers

SYSTEM SPECIFICATIONS

Input voltage	
United States	115 AC 50/60 Hz
International	100-240 AC 50/60 Hz
Input power	200 VA
Max flow	1.5 GPM
Pressure setting	87 PSI (6 BAR)
Tank	4 GAL, SS304, butyl bladder
Weight	17.5 lb (7.9 Kg)
System certification	NSF 18 Component
Pump certifications	NSF 18, UL Listed (US only)
Tank certification	NSF 61
Max pump inlet pressure	30 PSI (2 BAR)

FEATURES

- Ultimate performance and reliability
- Self priming pump, run dry without damage
- Stainless steel tank with replaceable bladder
- Ultra fast response , pump switch cut in time

PERFORMANCE (DRAW DOWN CURVES)

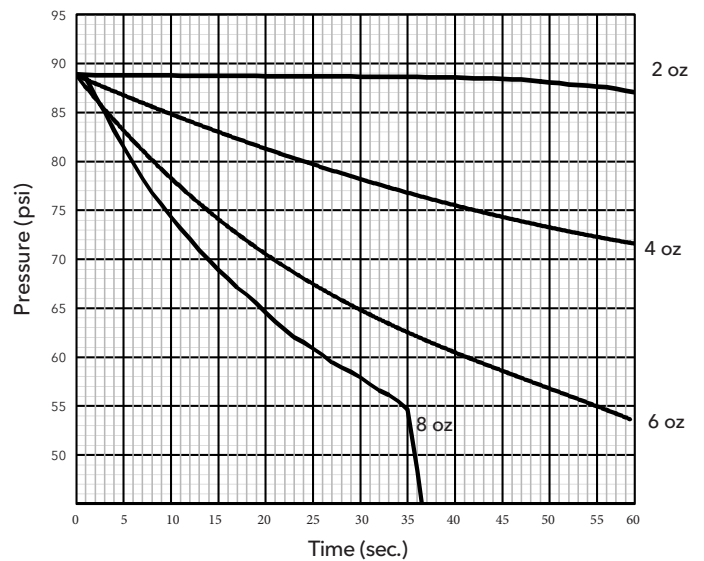

Tested with 30 psi incoming water pressure and 60 psi accumulator pre-charge pressure

DIMENSIONAL DRAWING

Inches (millimeters)

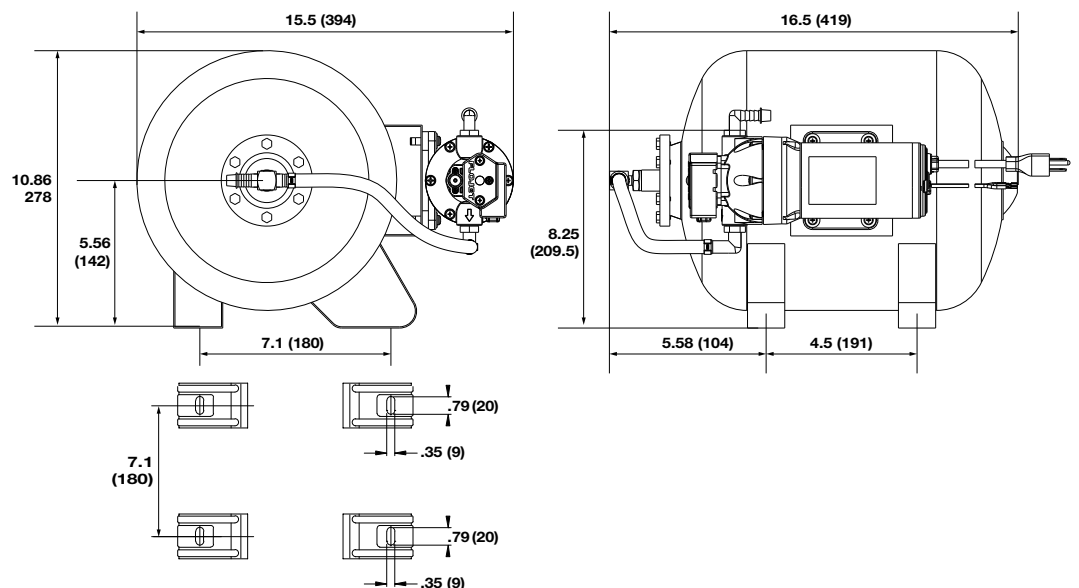

INSTALLATION & OPERATION

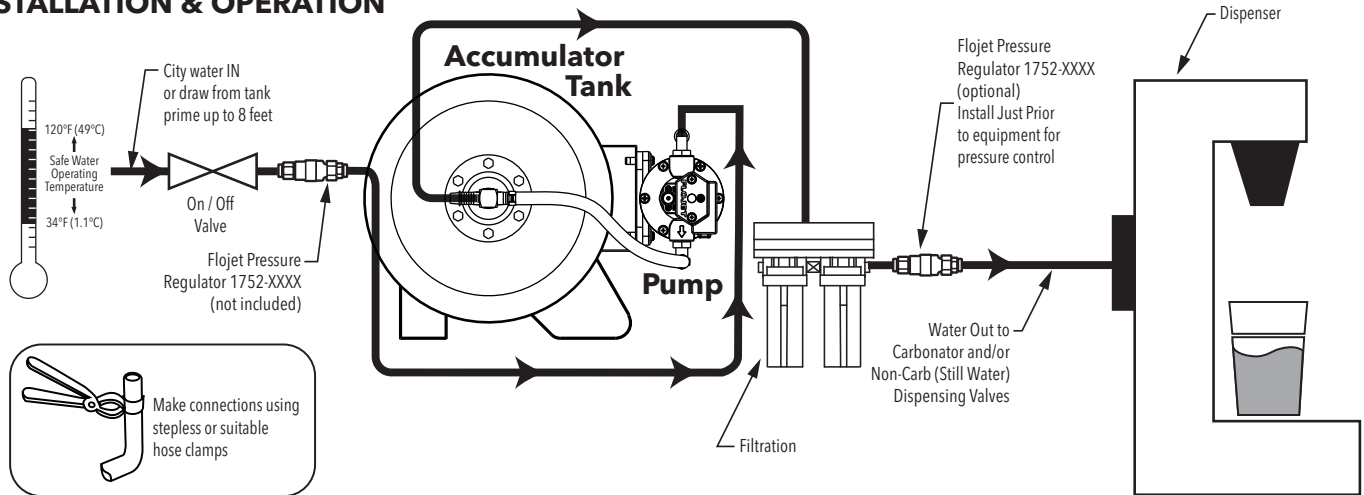

1. Install the booster and power supply indoors, in an area protected from splash, spillage, or soiling.
2. Install service valves (not included) before and after the system as required to create a system bypass loop.
3. Note: For incoming water supply line install a 30 psi (2.1 bar) Flojet pressure regulator PN#01752-XXXX (not included with all models). Failure to do so may void warranty.
4. Adjust precharge pressure on accumulator tank to label specified pressure using air or nitrogen only. Failure to do so may void warranty.
⚠ Warning: Do not use CO₂ for accumulator precharge.
5. Connect inlet and outlet fittings to suitably rated hose using stainless stepless clamps.
6. Turn on incoming water. Plug in the system and open outlet valves and purge air from the system.
7. Inspect systems and installation for leaks and proper function.
8. Periodically check accumulator pre-charge and re-pressurize as required to proper setting. See system label.

Cautions and Warnings

- ⚠ RISK OF AN ELECTRICAL SHOCK!**
Follow all local and electrical and safety codes NEC and OSHA. Install in a GFI protected outlet for maximum protection. Disconnect power before servicing the unit.
- ⚠ For use with water only.** Do not pump flammable liquids. Do not use in a flammable environment.
- ⚠ Caution: Pressurized System;** Release pressure from accumulator tank and system prior to servicing.
- ⚠ Warning: Do not use CO₂ for accumulator precharge.** CO₂ mixed with water and brass components can create a hazardous chemical reaction.
- ⚠ After any "Water Boil Warning or Water boil Advisory" is lifted,** be sure to completely flush and sanitize your system. Remove and replace the bladder in the tank or replace the tank as needed. Test water as necessary to be sure contaminants are no longer present.
- ⚠ Regulate incoming water pressure to 30 psi (2 bar) max.**
- ⚠ Tank must be pre-charged with air to 50-60 psi (3.4-4 bar).**

XYLEM LIMITED WARRANTY WARRANTS THIS PRODUCT TO BE FREE OF DEFECTS AND WORKMANSHIP FOR A PERIOD OF 1 YEAR. THE WARRANTY IS EXCLUSIVE AND IN LIEU OF ANY AND ALL OTHER EXPRESS OR IMPLIED WARRANTIES, GUARANTEES, CONDITIONS OR TERMS OF WHATEVER NATURE RELATING TO THE GOODS PROVIDED HEREUNDER, INCLUDING WITHOUT LIMITATION ANY IMPLIED WARRANTIES OF MERCHANTABILITY AND FITNESS FOR A PARTICULAR PURPOSE, WHICH ARE HEREBY EXPRESSLY DISCLAIMED AND EXCLUDED. EXCEPT AS OTHERWISE PROVIDED BY LAW, BUYER'S EXCLUSIVE REMEDY AND SELLER'S AGGREGATE LIABILITY FOR BREACH OF ANY OF THE FOREGOING WARRANTIES ARE LIMITED TO REPAIRING OR REPLACING THE PRODUCT AND SHALL IN ALL CASES BE LIMITED TO THE AMOUNT PAID BY THE BUYER HEREUNDER. IN NO EVENT IS SELLER LIABLE FOR ANY OTHER FORM OF DAMAGES, WHETHER DIRECT, INDIRECT, LIQUIDATED, INCIDENTAL, CONSEQUENTIAL, PUNITIVE, EXEMPLARY OR SPECIAL DAMAGES, INCLUDING BUT NOT LIMITED TO LOSS OF PROFIT, LOSS OF ANTICIPATED SAVINGS OR REVENUE, LOSS OF INCOME, LOSS OF BUSINESS, LOSS OF PRODUCTION, LOSS OF OPPORTUNITY OR LOSS OF REPUTATION. THIS WARRANTY IS ONLY A REPRESENTATION OF THE COMPLETE LIMITED WARRANTY. FOR A DETAILED EXPLANATION, PLEASE VISIT US AT www.xylemflowcontrol.com/support, CALL OUR OFFICE NUMBER LISTED, OR WRITE A LETTER TO YOUR REGIONAL OFFICE.

www.flojet.com

Jabsco, 17942 Cowan Irvine, CA 92614
Tel: +1 949 608 3900 Fax: +1 949 608 3887
Jabsco, Bingley Road, Hoddesdon, Hertfordshire, EN11 0BU
Tel: +44 (0) 1992 450 145 Fax: +44 (0) 1992 467 132
Jabsco GmbH, Oststraße 28, 22844 Norderstedt
Tel: +49 (0) 40 53 53 73 0 Fax: +49 (0) 49 53 53 73 11
Jabsco Italia, s.r.l., Via Tommaseo, 6, 20059 Vimercate, Milano
Tel: +39 039 685 2323 Fax: +39 039 666 307

USA
UK
GERMANY
ITALY

FLOJET
a xylem brand